

PROPRIETARY AND CONFIDENTIAL
 THE INFORMATION CONTAINED IN THIS DRAWING IS THE SOLE PROPERTY OF
 CAPSTAN AG INC. ANY REPRODUCTION IN PART OR AS A WHOLE
 WITHOUT WRITTEN PERMISSION OF CAPSTAN AG INC IS PROHIBITED

| REV | ECR | DESCRIPTION | DATE | BY |
|-----|------|---|----------|-----|
| 1 | | Preliminary Release | 9/25/13 | BLS |
| A | 1023 | Note 2, App Code 1.0.25.txt was 1.0.22.txt | 11/20/14 | BLS |
| B | 1024 | Added item 14, application code 962001-025, to bill of materials | 11/25/14 | BLS |
| C | 2014 | Item 4, 120020-002 was 120020-001 | 3/31/16 | BLS |
| D | 2042 | Note 1, Boot Code, 1.0.36 was 1.0.35 | 7/25/16 | BLS |
| E | 2182 | item 14, 962001-027 was 962001-025 App code, 1.0.27 was 1.0.25 | 6/7/17 | BLS |

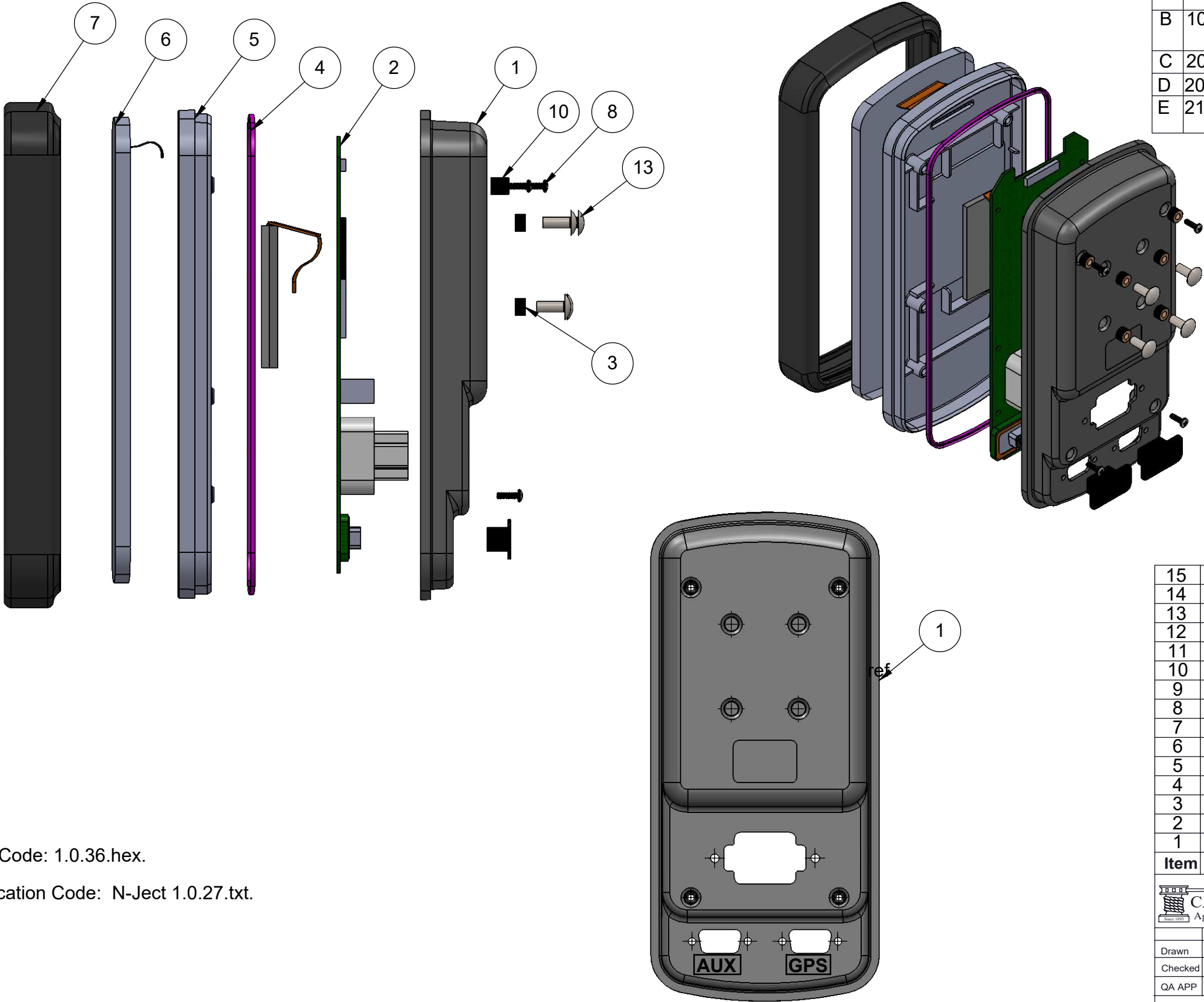

Notes:

1. Boot Code: 1.0.36.hex.
2. Application Code: N-Ject 1.0.27.txt.

| 15 | S1000-210 | Foam Set, SSRS | 1 |
|------|-------------|--------------------------------|-----|
| 14 | 962001-027 | App code, N-Ject, 1.0.27.txt | |
| 13 | 709031-803 | Screw, 10-24 x 1/2 PH Phillips | 4 |
| 12 | 120140-009 | Screwlock 4-40 M/F Hex | 4 |
| 11 | 709031-203 | Screw, 6-19 x 5/8 Plastite | 2 |
| 10 | 708992-202 | Insert, Threaded, 4-40 | 5 |
| 9 | 708992-102 | Screw, 4-40 Pan Hd | 5 |
| 8 | 626100-001 | Outer Band, Cab Box | 1 |
| 7 | 620900-001 | Key Pad, Cab Box | 1 |
| 6 | 626100-002 | Front, Cab Box | 1 |
| 5 | 118551-106 | O-Ring Gasket, Cab Box | 23" |
| 4 | 120020-001 | 3.5 in LCD | 1 |
| 3 | 708992-203 | Insert, Threaded, 10-24 | 4 |
| 2 | 118551-105 | Circuit Board, Cab Box | 1 |
| 1 | 626100-003 | Back, Cab Box | 1 |
| Item | Part Number | Description | Qty |

| | | | |
|---------|-----|---|---------------------------|
| | | CAPSTAN AG SYSTEMS, INC. 101 N. KANSAS AVE., TOPEKA, KS 66603 | |
| Drawn | BLS | Date | 9/25/13 |
| Checked | | | |
| QA APP | | | |
| | | TITLE: Cab Box Assy N-Ject | |
| | | SIZE: B | DWG No: 620131-002 |
| | | SCALE: None | REV E |
| | | SHEET 1 of 1 | |