

REV	DESCRIPTION	DATE	BY
A	Prod Rel. Groove Dims. Changed, Added Note 5	04/18/03	JJG
B	Revised Part Name	5/16/03	RDC
C	Groove ID was 5.294" Chgd RMS on Groove, surface, bore. O-ring bore was .810-.815 and .935-.940	1/24/14	ADL

ID	PART NUMBER	DESCRIPTION	QTY
1	620102-001	Slice Casting	1

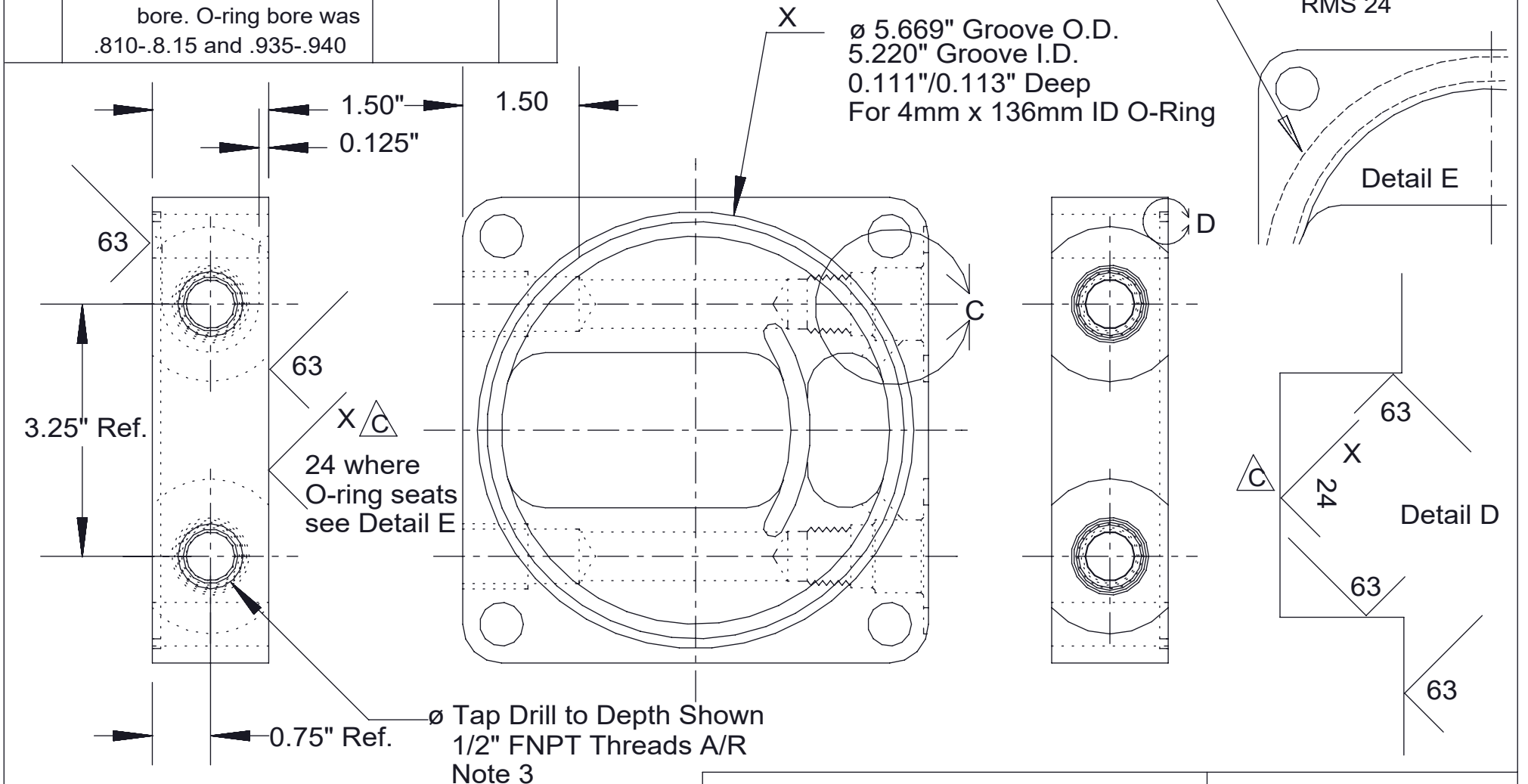

No porosity marks allowed on seal surfaces marked "X".
Finished parts must not leak during 300psi water leak test.
Pressure treating with Sodium Silicate by permission only.

CAPSTAN AG SYSTEMS, INC.
101 N. KANSAS AVE., TOPEKA, KS 66603

Slice, Dual Port
Machined

DATE	BY	SCALE	PAGE	SIZE
10/31/00	JJG	1" = 2"	1 of 2	A

620103-001