

## 1.0 - INSTALLATION INSTRUCTIONS - 118155-011 Rev. A

### *PinPoint® Synchro Cable Installation*

- Models - Apache Sprayers with PWM Control or Bypass Servo

**KIT NUMBER - 118669-302**

For safety information see the system and machine manuals.

- [Figure 1]** - Locate the PWM cartridge extension wire or bypass servo on the left side of the center boom frame.

PWM cartridges and newer servo valves will have a 2-pin Deutsch connector (1), as shown.

Older servo valves will have molded 2-pin connector use provided adapters 118669-204 and 118669-203 to convert the molded 2-pin connections to a Deutsch connector

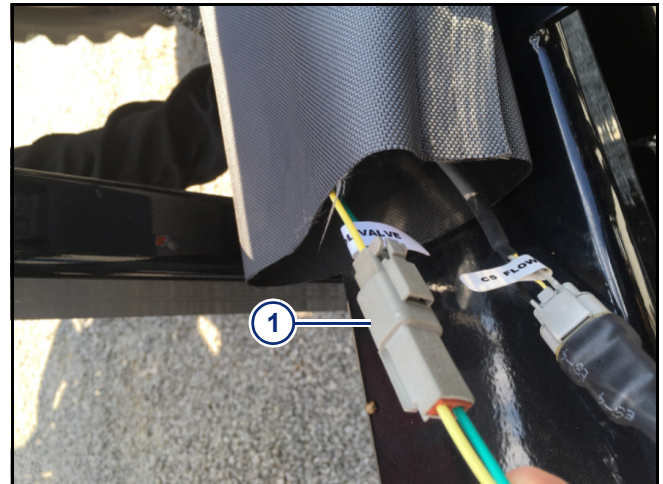

**Figure 1**

Only necessary for PWM Cartridge pump control. If a Bypass servo is installed move to Step 3.

- [Figure 2]** - Install the 2-wire resistor adapter (1) provided in the kit onto the wire removed from PWM cartridge in Step 1.

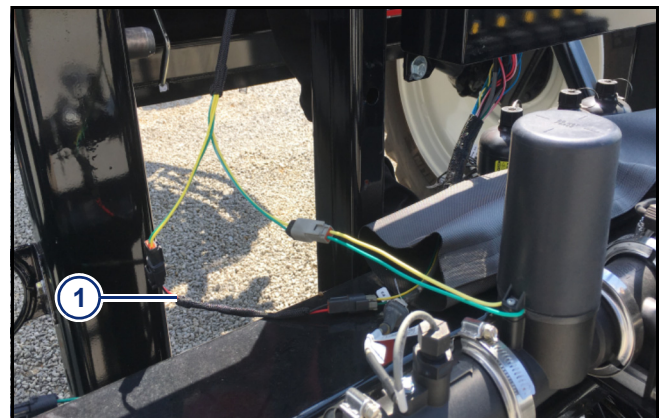

**Figure 2**

3. **[Figure 3]** - Install the Synchro adapter cable (1) onto the 2-wire resistor adapter (if applicable) and into the valve or extension wire going to the PWM cartridge.



**Figure 3**

4. Route the cable along the boom frame towards the right side of the sprayer to the existing PinPoint® wiring going to the Gateway Hub. Secure the harnesses and keep away from pinch points.
5. **[Figure 4]** - Plug in the 8-pin connection into the Servo port on the Gateway Hub as shown.

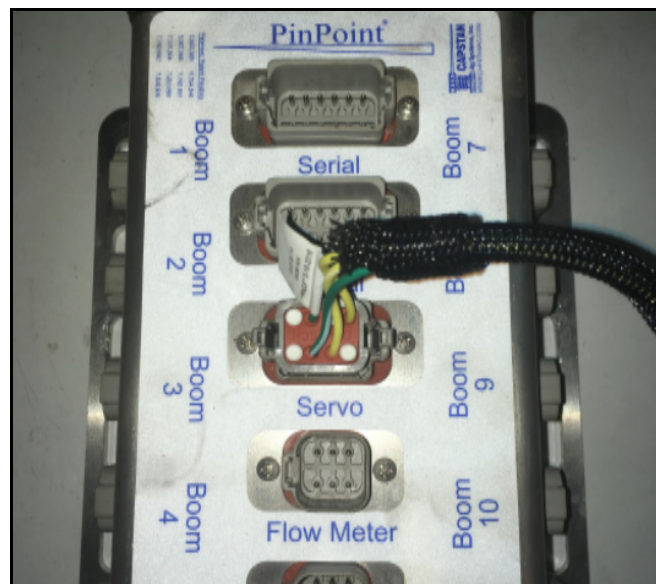

**Figure 4**