

PROPRIETARY AND CONFIDENTIAL
 THE INFORMATION CONTAINED IN THIS DRAWING IS THE SOLE PROPERTY OF
 CAPSTAN AG INC. ANY REPRODUCTION IN PART OR AS A WHOLE
 WITHOUT WRITTEN PERMISSION OF CAPSTAN AG INC IS PROHIBITED

Rev	ECR	Description	Date	By	App
A	2020	Production Release	4/1/16	BLS	

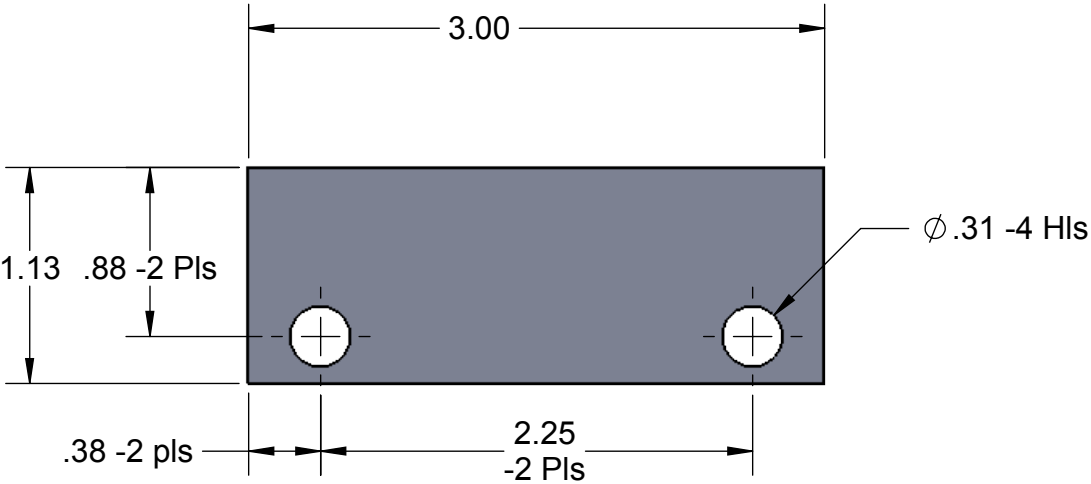
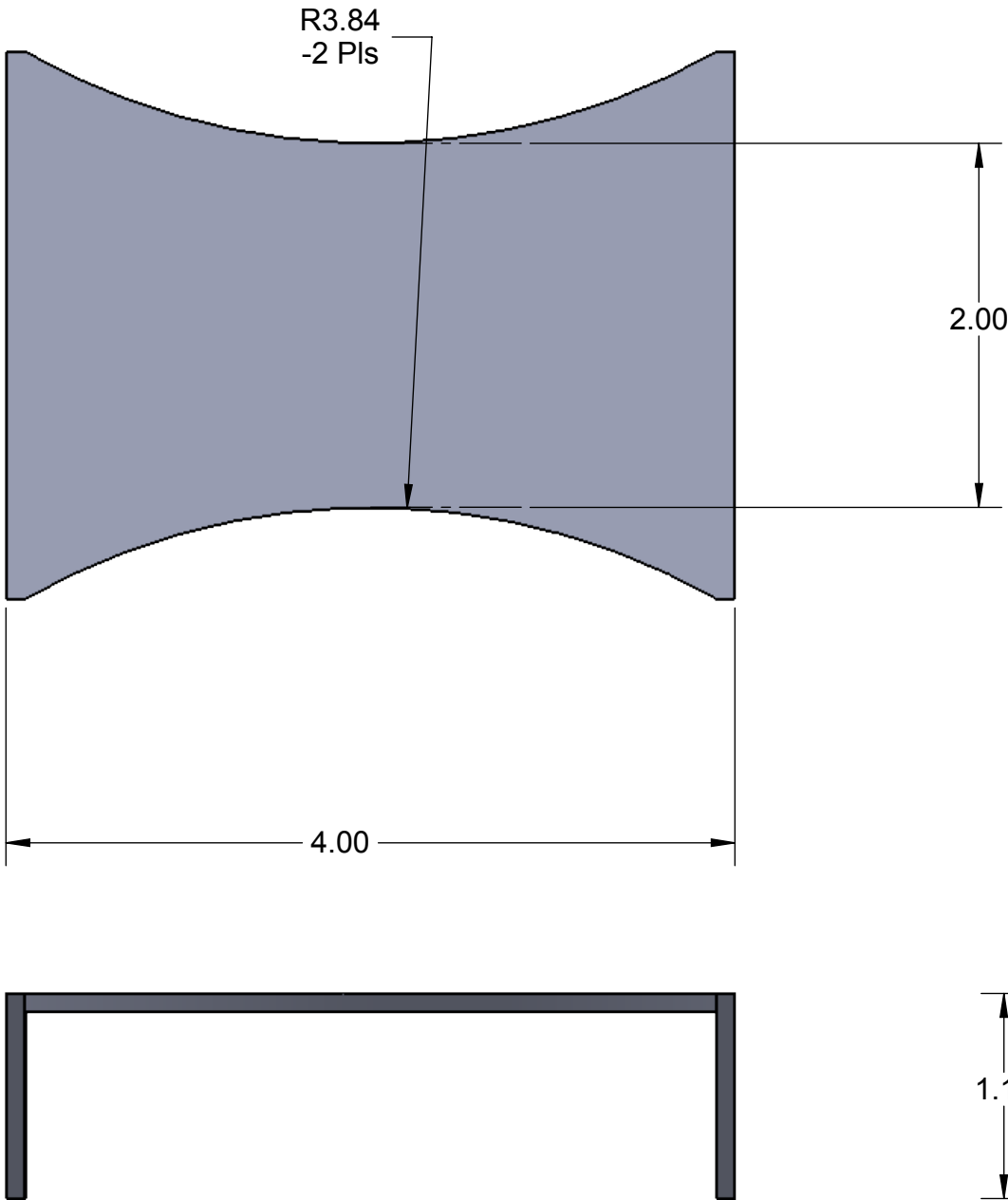

Material; 12ga. Steel.
 Finish: Powder Coat Charcol Gray.

UNLESS OTHERWISE SPECIFIED:		<div><div><div><div></div><div>Since 1997</div></div><div><div>CAPSTAN</div><div>Ag Systems, Inc.</div></div></div><div>APPLICATION SYSTEMS FOR PROFESSIONALS</div></div>		<div><div>CAPSTAN AG SYSTEMS, INC.</div><div>4225 S.W. Kirklawn Ave., Topeka, KS 66609</div></div>	
DIMENSIONS ARE IN INCHES TOLERANCES: FRACTIONAL ± ANGULAR: MACH ± BEND ± TWO PLACE DECIMAL ± THREE PLACE DECIMAL ± INTERPRET GEOMETRIC TOLERANCING PER:		<div><div></div><div>Name</div></div>	<div><div></div><div>Date</div></div>	TITLE:	
		<div><div>Drawn</div><div>BLS</div></div>	<div><div>4/1/16</div></div>	Pump Bracket, Electric Pump	
		<div><div>Checked</div></div>	<div><div></div></div>		
MATERIAL		<div><div>QA APP</div></div>	<div><div></div></div>		
FINISH				<div><div>SIZE</div><div>B</div></div>	<div><div>DWG No:</div><div>115600-015</div></div>
DO NOT SCALE DRAWING				<div><div>SCALE:</div><div>None</div></div>	<div><div>REV</div><div>A</div></div>
				SHEET 1 of 1	