

PROPRIETARY AND CONFIDENTIAL
THE INFORMATION CONTAINED IN THIS DRAWING IS THE SOLE PROPERTY OF
CAPSTAN AG INC. ANY REPRODUCTION IN PART OR AS A WHOLE
WITHOUT WRITTEN PERMISSION OF CAPSTAN AG INC IS PROHIBITED

Rev	ECR	Description	Date	By	App
A	2074	Production Release	11/29/16	BLS	

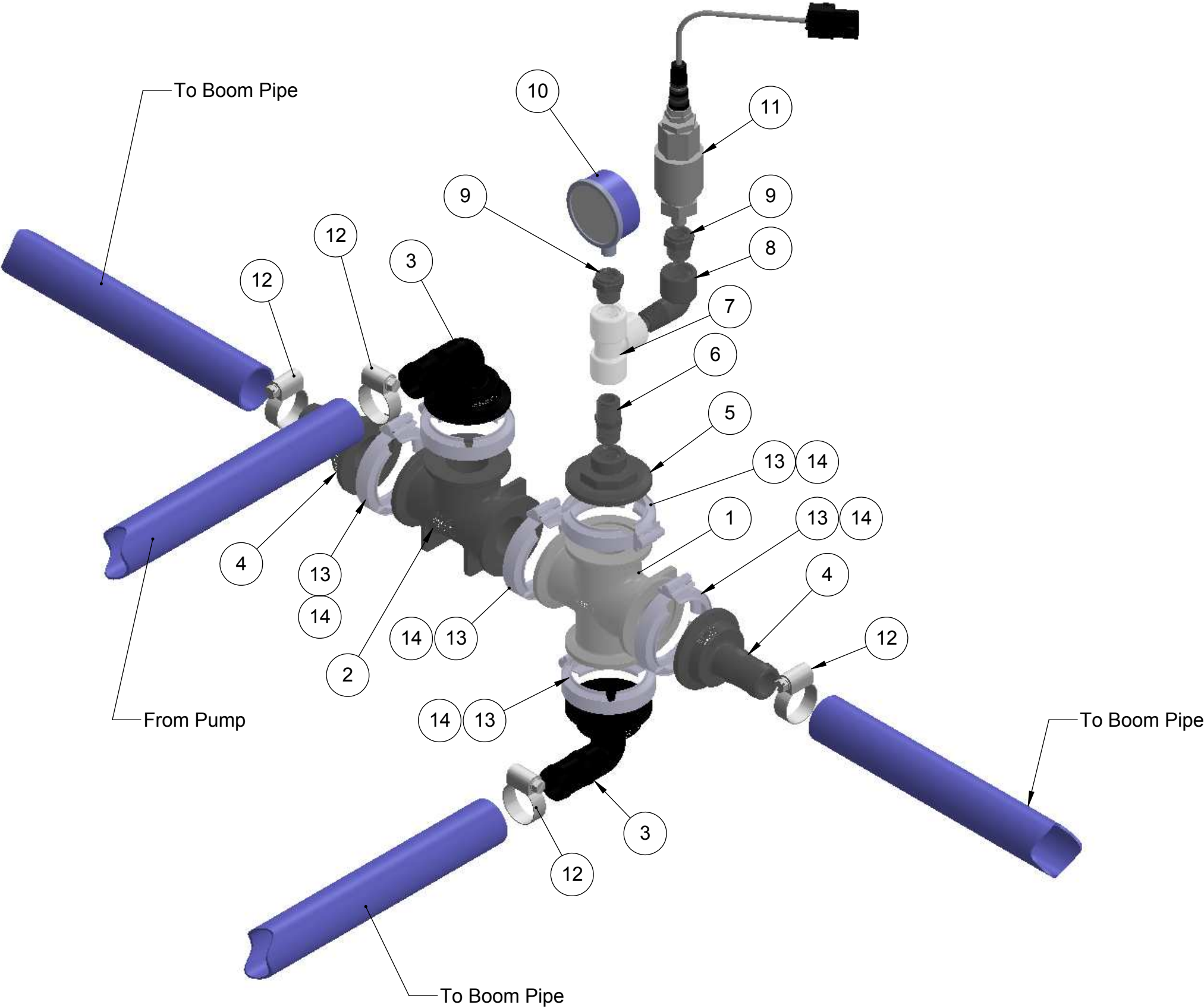

14	HY UFG0150E	Hypro, Clamp Flange Gasket	6
13	TKFC200	Clamp, Flanged, 2 "	6
12	MP620-20	Hose Clamp, 1" (3/4" - 1-3/4")	4
11	116301-001	Pressure Sensor, 100 psi	1
10	AHWGGSS100-4	Gauge, 4" 100 psi Stainless	1
9	TK901-1/2x1/4	1/2" x 1/4" Reducer Bushing	2
8	TK908-1/2	1/2" Street Elbow	1
7	TK906-1/2	1/2" NPT Tee	1
6	TK900-1/2XCL	1/2" Close Nipple	1
5	TKM200PLG050	Flange Plug 2" w/1/2" FPT, Adapt	1
4	TKM701D	2" Flanged, 1" Hose Barb	2
3	TKM702D	Elbow, 90, 2" Flanged, 1" Hose	2
2	TKM200TEE	2" Flanged, Tee	1
1	TKM200CR	2" Flanged, Cross	1
Item	Part Number	Description	Qty



Drawn	Name	Date	TITLE: Assembly, Pressure Tree Boom Pipes 2 & 3 Sections		
Checked	BLS	11/17/16			
QA APP					
		SIZE	DWG No:	REV	
		B	115300-015	A	
SCALE: None			SHEET 1 of 1		